

Miniature 400 Hz Transformers

5 VA to 50VA

115V/26V Primary

1. Manufactured in accordance with MIL-PRF-27, Grade 5, Class S
2. 90°C Ambient
3. Input Primary 115V-400 Hz ± 20 Hz or 26V-400Hz ± 20 Hz
4. Regulation is 8%
5. Secondary Voltage Adjusted to Nominal Value at Half-Load
6. 400 Hz Aerospace Application.
7. Smallest Possible Size.
8. Printed Circuit Plug-In and Surface-mount Construction
9. Operating Temperature: -55°C to 130°C

Electrical Characteristics:

Model Number 115V Primary	Model Number 26V Primary	Sec/Current mA	Sec/Volt	Weight
5T6155-151-X	5T6155-251-X	1000	5.0 CT	52
5T6155-152-X	5T6155-252-X	3000		65
5T6155-153-X	5T6155-253-X	5000		100
5T6155-154-X	5T6155-254-X	7000		145
5T6155-155-X	5T6155-255-X	10000		195
5T6155-161-X	5T6155-261-X	833	6.0 CT	52
5T6155-162-X	5T6155-262-X	2500		65
5T6155-163-X	5T6155-263-X	4166		100
5T6155-164-X	5T6155-264-X	5833		145
5T6155-165-X	5T6155-265-X	8333		195
5T6155-191-X	5T6155-291-X	555	9.0 CT	52
5T6155-192-X	5T6155-292-X	1666		65
5T6155-193-X	5T6155-293-X	2777		100
5T6155-194-X	5T6155-294-X	3888		145
5T6155-195-X	5T6155-295-X	5555		195
5T6155-1121-X	5T6155-2121-X	417	12 CT	52
5T6155-1122-X	5T6155-2122-X	1250		65
5T6155-1123-X	5T6155-2123-X	2083		100
5T6155-1124-X	5T6155-2124-X	2917		145
5T6155-1125-X	5T6155-2125-X	4166		195
5T6155-1141-X	5T6155-2141-X	357	14 CT	52
5T6155-1142-X	5T6155-2142-X	1071		65
5T6155-1143-X	5T6155-2143-X	1786		100
5T6155-1144-X	5T6155-2144-X	2500		145
5T6155-1145-X	5T6155-2145-X	3571		195
5T6155-1151-X	5T6155-2151-X	333	15 CT	52
5T6155-1152-X	5T6155-2152-X	1000		65
5T6155-1153-X	5T6155-2153-X	1667		100
5T6155-1154-X	5T6155-2154-X	2333		145
5T6155-1155-X	5T6155-2155-X	3333		195

*Configuration: X noting use type--S=Surface-mount and P=Plug-in

Continued...

Model Number 115V Primary	Model Number 2.6V Primary	Sec/Current mA	Sec/Volt	Weight
5T6155-1221-X	5T6155-2221-X	227	22 CT	52
5T6155-1222-X	5T6155-2222-X	681		65
5T6155-1223-X	5T6155-2223-X	1136		100
5T6155-1224-X	5T6155-2224-X	1591		145
5T6155-1225-X	5T6155-2225-X	2272		195
5T6155-1241-X	5T6155-2241-X	208	24 CT	52
5T6155-1242-X	5T6155-2242-X	625		65
5T6155-1243-X	5T6155-2243-X	1041		100
5T6155-1244-X	5T6155-2244-X	1450		145
5T6155-1245-X	5T6155-2245-X	2083		195
5T6155-1281-X	5T6155-2281-X	178	28 CT	52
5T6155-1282-X	5T6155-2282-X	535		65
5T6155-1283-X	5T6155-2283-X	892		100
5T6155-1284-X	5T6155-2284-X	1250		145
5T6155-1285-X	5T6155-2285-X	1786		195
5T6155-1361-X	5T6155-2361-X	138	36 CT	52
5T6155-1362-X	5T6155-2362-X	416		65
5T6155-1363-X	5T6155-2363-X	694		100
5T6155-1364-X	5T6155-2364-X	972		145
5T6155-1365-X	5T6155-2365-X	1389		195
5T6155-1481-X	5T6155-2481-X	104	48 CT	52
5T6155-1482-X	5T6155-2482-X	312		65
5T6155-1483-X	5T6155-2483-X	521		100
5T6155-1484-X	5T6155-2484-X	729		145
5T6155-1485-X	5T6155-2485-X	1043		195
5T6155-1751-X	5T6155-2751-X	67	75 CT	52
5T6155-1752-X	5T6155-2752-X	200		65
5T6155-1753-X	5T6155-2753-X	333		100
5T6155-1754-X	5T6155-2754-X	467		145
5T6155-1755-X	5T6155-2755-X	676		195
5T6155-11001-X	5T6155-21001-X	50	100 CT	52
5T6155-11002-X	5T6155-21002-X	150		65
5T6155-11003-X	5T6155-21003-X	250		100
5T6155-11004-X	5T6155-21004-X	350		145
5T6155-11005-X	5T6155-21005-X	500		195
5T6155-11101-X	5T6155-21101-X	45	110 CT	52
5T6155-11102-X	5T6155-21102-X	136		65
5T6155-11103-X	5T6155-21103-X	227		100
5T6155-11104-X	5T6155-21104-X	318		145
5T6155-11105-X	5T6155-21105-X	454		195
5T6155-11151-X	5T6155-21151-X	43	115 CT	52
5T6155-11152-X	5T6155-21152-X	130		65
5T6155-11153-X	5T6155-21153-X	217		100
5T6155-11154-X	5T6155-21154-X	304		145
5T6155-11155-X	5T6155-21155-X	434		195

*Configuration: X noting use type--S=Surface-mount and P=Plug-in
Last numerical digit references size of unit

Continued...

Mechanical Dimensions:

Plug-in construction

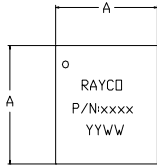

Dimensions: Inches.
Unless otherwise specified,
all tolerances are .010 inches.
White dot indicates pin #1

Surface-mount construction

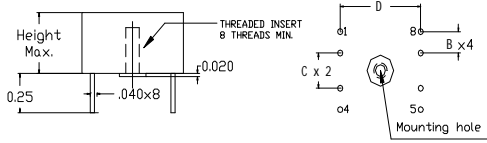
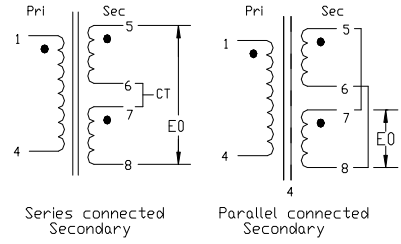
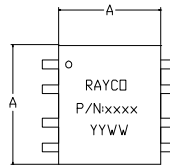

Suggested pcb layout

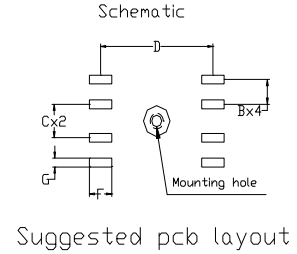
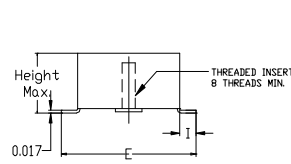

Suggested pcb layout

Size	Max Height		A	B	C	D		E	F	G	Insert
	Surface mount	Plug-in				Surface mount	Plug-in				
1	0.725 (18.42)	.700 (17.78)	1.375 (34.93)	.300 (7.62)	.400 (10.16)	1.500 (38.10)	1.180 (29.98)	1.625 (41.27)	0.225 (5.72)	0.125 (3.17)	6-32 UNC
2	0.800 (20.32)	.825 (20.95)	1.500 (38.10)	.300 (7.62)	.500 (12.70)	1.625 (41.27)	1.330 (33.76)	1.750 (44.45)	0.225 (5.72)	0.125 (3.18)	6-32 UNC
3	0.850 (21.59)	.825 (20.95)	1.625 (41.28)	.300 (7.62)	.700 (17.78)	1.750 (44.45)	1.400 (35.57)	1.875 (47.63)	0.250 (6.35)	0.125 (3.19)	6-32 UNC
4	0.950 (24.13)	.925 (23.49)	1.750 (44.45)	.300 (7.62)	.800 (20.32)	1.875 (47.63)	1.570 (39.89)	2.000 (50.80)	0.250 (6.35)	0.125 (3.20)	6-32 UNC
5	1.050 (26.67)	1.025 (26.03)	2.000 (50.80)	.300 (7.62)	.900 (22.86)	2.125 (53.98)	1.800 (45.73)	2.250 (57.15)	0.250 (6.35)	0.125 (3.21)	6-32 UNC

All dimensions are in inches (mm).